

Peacefulness	★★★★☆☆
View	★★★★☆☆
Living room	★★★★☆☆
Rooms	★★★★☆☆
Bathrooms	★★★★☆☆
Kitchen	★★★★★★



www.villasinitaly.biz



Acquaforte is located in the middle of the Chianti countryside on a hill 300 metres above sea level. Acquaforte is one of eight restored maisonettes and villas that comprise Tuscan Estate.

Main house:

This newly renovated is situated on the ground floor of a wing belonging to Villa Affresco, an ancient Medician villa. It can be completely independent and has it's own entrance.

Acquaforte has 1 double bedroom with queen-size bed and an ensuite bathroom, and a further double bedroom with 2 twin beds. A small bathroom with a shower is situated in the hallway.

There is a large room, where on one side is placed a nice kitchen with all modern conveniences and a table and chairs; a living-room with sofa and armchairs and a fireplace. Everything is very neat and tastefully decorated.

Beds & Baths

Sleeps up to 4 adults. (2 bedrooms & 2 baths). One double bedroom with one Queen-size bed and ensuite bathroom and the other bedroom with two twin beds. A small bathroom with a shower is situated in the hallway.

Living Space

Large room, divided in two sections. Kitchen with all modern conveniences, table and chairs and a living-room with sofa, armchairs and a fireplace.

Outdoors

The property is surrounded by maturing gardens and vineyards.

Outside the gates of Acquaforte you will be part of the most attractive views of the hilly Tuscan Chianti country side. Shared swimming pool (approx 14 x 8 mt).

Household Essentials

Kitchen with all modern conveniences. TV, Satellite TV, Telephone, Internet connection Wireless.

washing machine, dishwasher, electric oven, iron, safety box, private parking lot, barbecue.

Notable Features

- Concierge services
- In the middle of the Chianti countryside on a hill 300 metres above sea level.
- peaceful, in the middle of vineyard
- proximity to wine canteens of Chianti region.
- half an hour away from Florence.
- SOS (Secrets of Savings) Excursion is available on request, enjoy a full or half day shopping excursion buying the best products at factory prices!.

Nearby Diversions

S. Gimignano (18kms), Greve Chinate (20 kms) Siena (15kms).

Half an hour away from Florence and proximity to wine canteens of Chianti region.

Supermarket and mini-market, restaurants and bank (with ATM) at approx 1 km.

Petrol Station 24 Hours Service: 3 Km.

Outdoor Activities

Horseback riding, Golf, Tennis, Trekking, Fishing.

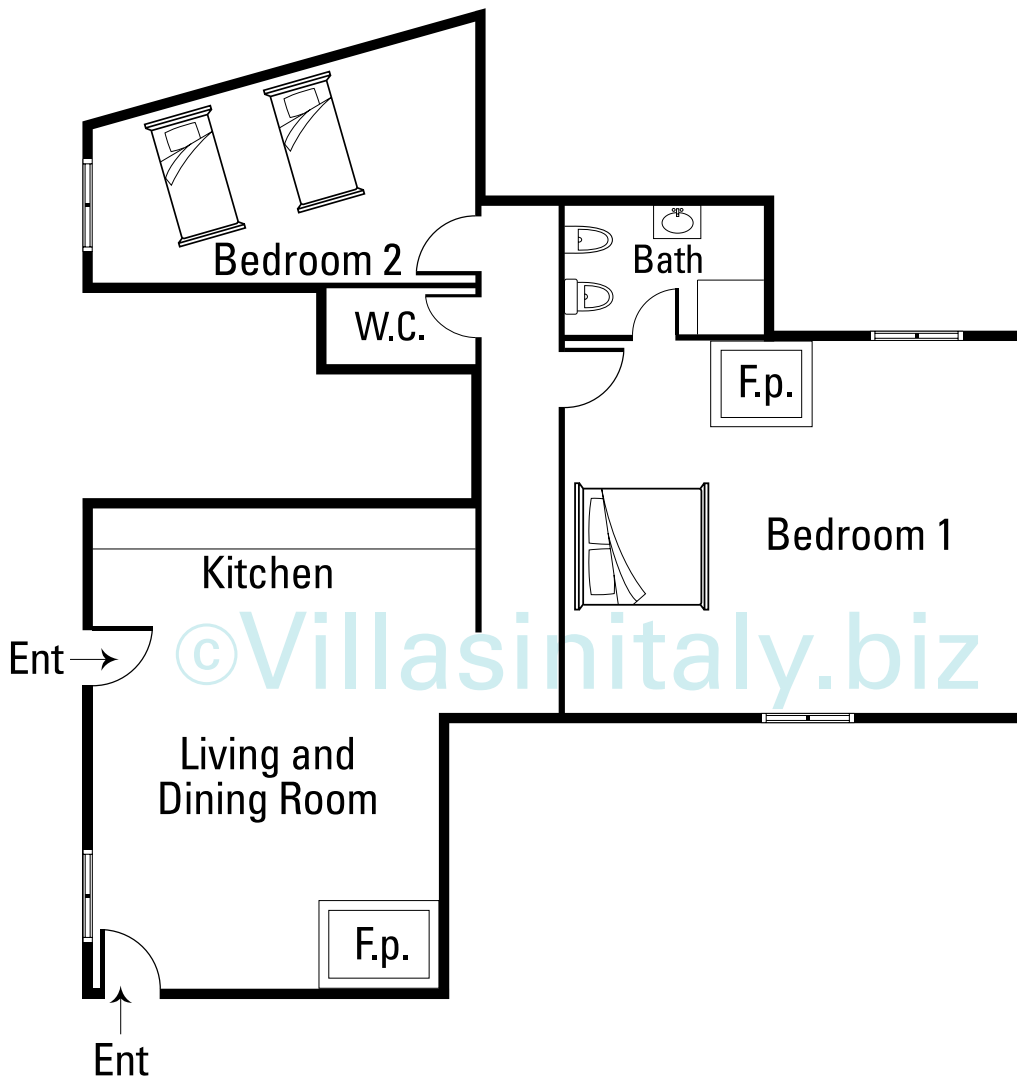

Acquaforte